

# KATANA®

## 2Ah & 4Ah BATTERY INSTRUCTION MANUAL

18V CHARGE-ALL

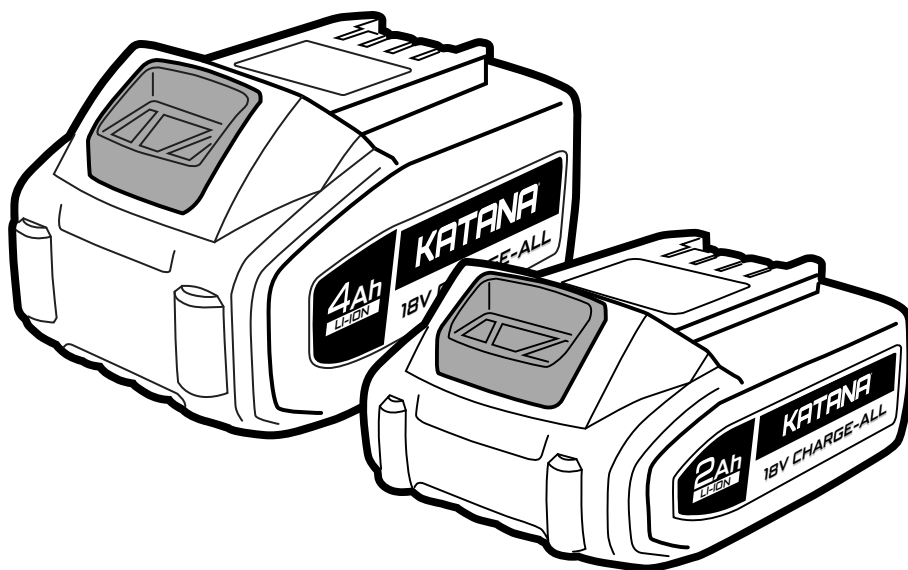

3 YEAR  
WARRANTY

18V  
LITHIUM ION

220350 (2Ah)  
220370 (4Ah)

## GENERAL POWER TOOL SAFETY WARNINGS

220350(2Ah) / 220370(4Ah)



1. **SAVE THESE INSTRUCTIONS - THIS OPERATOR'S MANUAL CONTAINS IMPORTANT SAFETY AND OPERATING INSTRUCTIONS FOR KATANA® LI-ION BATTERY PACKS AND THE LI-ION CHARGER.**
2. **BEFORE USING THE BATTERY PACK AND CHARGER, READ THIS OPERATOR'S MANUAL, YOUR TOOL OPERATOR'S MANUAL, AND ALL LABELS ON THE BATTERY PACK, CHARGER AND TOOL.**
3. **CAUTION - TO REDUCE THE RISK OF INJURY, CHARGE LITHIUM-ION PACKS ONLY IN THEIR LITHIUM-ION CHARGER.**  
*Other types of chargers may cause personal injury or damage. Do not wire a battery pack to a power supply plug or car cigarette lighter. Battery packs will be prematurely fail.*
4. **USE LITHIUM-ION PACKS ONLY ON COMPATIBLE LITHIUM-ION TOOLS.**
5. **AVOID DANGEROUS ENVIRONMENTS.**  
*Do not charge battery pack in rain, snow, damp or wet locations. Do not use battery pack or charger in the presence of explosive atmospheres (gaseous fumes, dust or flammable materials) because sparks may be generated when inserting or removing battery pack, possibly causing fire.*
6. **CHARGE IN A WELL VENTILATED AREA.**  
*Do not block charger vents. Keep them clear to allow proper ventilation. Do not allow smoking or open flames near a charging battery pack. Venting gases may explode.*
7. **DO NOT BURN OR INCINERATE BATTERY PACKS.**  
*Battery packs may explode, causing personal injury or damage. Toxic fumes and materials are created when battery packs are burned.*
8. **DO NOT CRUSH, DROP, OR DAMAGE BATTERY PACKS.**  
*Do not use a battery pack or charger that has received a sharp blow, been dropped, run over, or damaged in any way (e.g., pierced with a nail, hit with a hammer, stepped on).*
9. **DO NOT DISASSEMBLE.**  
*Incorrect reassembly may result in the risk of electric shock, fire or exposure to battery chemicals. If it is damaged contact KATANA Customer Service.*
10. **BATTERY CHEMICALS CAUSE SERIOUS BURNS.**  
*Never allow contact with skin, eyes, or mouth. If a damaged battery pack leaks battery chemicals, use rubber or neoprene gloves to dispose of it. If skin is exposed to battery fluids, wash with soap and water and rinse with vinegar. If eyes are exposed to battery chemicals, immediately flush with water for 20 minutes and seek medical attention. Remove and dispose of contaminated clothing.*
11. **DO NOT SHORT CIRCUIT.**  
*A battery pack will short circuit if a metal object makes a connection*

*between the positive and negative contacts on the battery pack. Do not place a battery pack near anything that may cause a short circuit, such as coins, keys or nails in your pocket. Do not allow fluids to flow into battery pack. Corrosive or conductive fluids, such as seawater, certain industrial chemicals, and bleach or bleach containing products, etc., can cause a short circuit. A short circuited battery pack may cause fire, personal injury, and product damage.*

### 12. STORE YOUR BATTERY PACK AND CHARGER IN A COOL DRY PLACE.

*Do not store battery pack where temperatures may exceed 40°C (104°F) such as in direct sunlight, a vehicle or metal building during the summer.*

### Battery charger safety instructions

1. *Before using the charger read all instructions and cautionary markings on the charger, battery pack and the product using the battery pack.*
2. *This charger is not intended for any uses other than charging rechargeable batteries. Any other use may result in risk of fire, electric shock or electrocution.*
3. *Do not place any object on top of the charger or place the charger on a soft surface that may result in excessive internal heat. Place the charger in a position away from any heat source.*
4. *To reduce risk of damage to the electric plug and cord, pull by the plug rather than the cord when disconnecting the charger.*
5. *Make sure the cord is located so that it will not be stepped on, tripped over, or otherwise subjected to damage or stress.*
6. *An extension cord should not be used unless absolutely necessary. Use of an improper extension cord could result in the risk of fire, electric shock or electrocution.*
7. *Do not operate the charger if it has received a sharp blow, been dropped or otherwise damaged in any way. Have it checked by an electrician or power tool repairer.*
8. *Do not disassemble charger. Take it to an electrician or power tool repairer when service or repair is required. Incorrect reassembly may result in a risk of electric shock, electrocution or fire.*
9. *To reduce risk of electric shock, unplug the charger from the outlet before attempting any cleaning. Removing the battery pack will not reduce this risk.*
10. *Never attempt to connect 2 chargers together.*
11. *DO NOT store or use the tool and battery pack in locations where the temperature may reach or exceed 40°C (such as inside sheds or metal buildings in summer).*
12. *The charger is designed to operate on standard household electrical power (240 volts). Do not attempt to use it on any other voltage!*
13. *The battery pack is not fully charged out of the carton. First read the safety instructions and then follow the charging notes and procedures. The longest life and best performance can be obtained if the battery pack is charged when the air temperature is between 18 - 24°C. Do not charge the battery pack in an air temperature below 10°C or above 40°C. This is important and will prevent damage to the battery pack.*
14. *Do not incinerate the battery pack even if it is seriously damaged or is completely worn out. The battery can explode in a fire.*
15. *Never attempt to open the battery pack for any reason. If the plastic housing of the battery pack breaks or cracks, immediately discontinue use and do not recharge.*
17. *During charging, the battery must be placed in a well ventilated area.*

## SYMBOLS

The rating plate on your tool may show symbols. These represent important information about the product or instructions on its use.

	Do not use battery in conditions above 40°C		Avoid & do not operate near or in open flame.
	Direct current, DC		Contains Lithium Ion. Waste electrical products should not be disposed of with household waste. Please recycle where facilities exist. Check with your Local Authority or retailer for recycling advice.
	Refer to instruction manual/booklet		
	General warning		Avoid & do not operate near or in water.

**KNOW YOUR PRODUCT**

**220350(2Ah) / 220370(4Ah)**

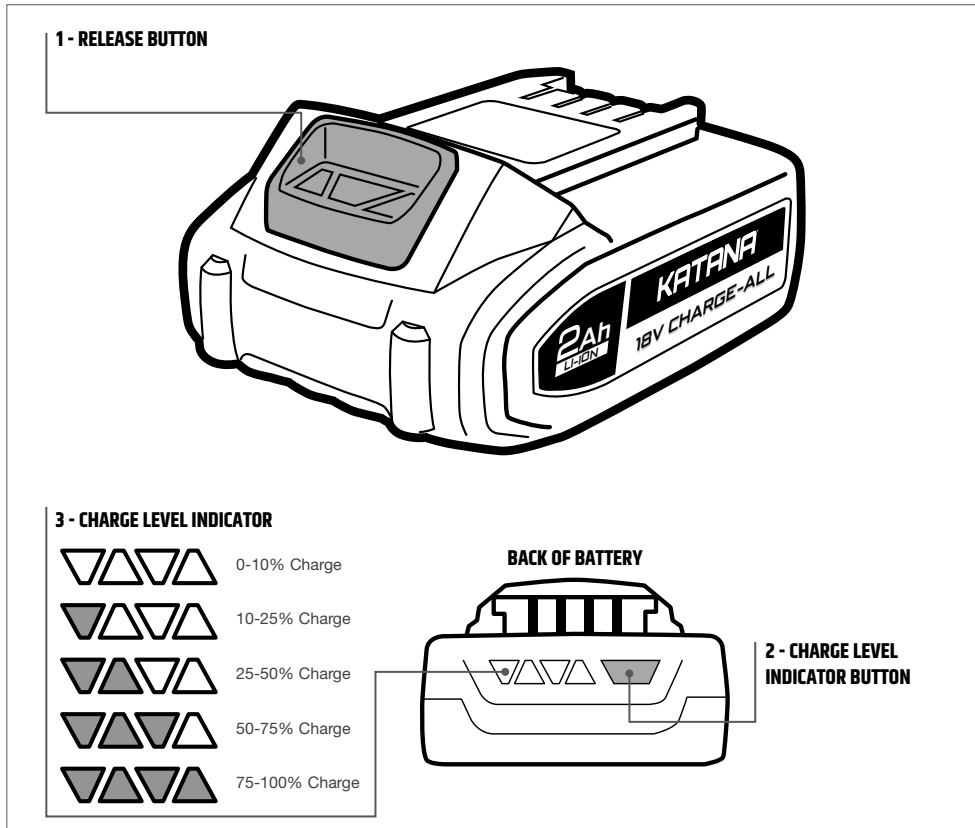

**HOW TO CHECK CHARGE LEVEL**

Check how much charge is left in the battery by pressing the charge level indicator button (2). Refer to Know Your Product (above) for charge level explanation.

**SPECIFICATIONS**

**2Ah Battery (220350)**

<b>Voltage</b>	18V d.c.
<b>Capacity</b>	2Ah
<b>Charge Time</b>	60 mins (Approx)
<b>Cell Type</b>	Lithium-Ion

**4Ah Battery (220370)**

<b>Voltage</b>	18V d.c.
<b>Capacity</b>	4Ah
<b>Charge Time</b>	130 mins (Approx)
<b>Cell Type</b>	Lithium-Ion

## HOW TO INSERT BATTERY ON CHARGER

220350(2Ah) / 220370(4Ah)

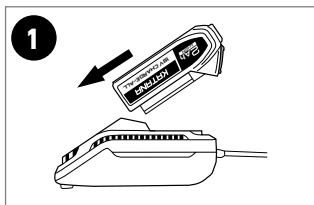

1. ALIGN BATTERY RIBS WITH CHARGER

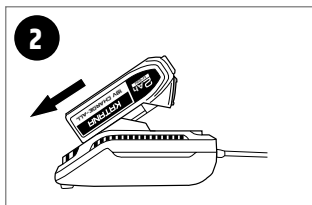

2. SLIDE INTO CHARGER

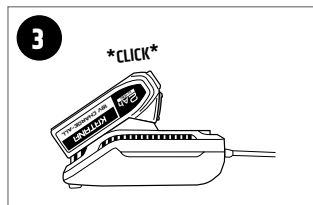

3. STOP WHEN YOU HEAR IT CLICK IN PLACE

**TO REMOVE BATTERY:** Press & hold release button (1) on battery & follow steps in reverse.

## SAFETY & MAINTENANCE

### SAFETY

A safety feature of the Katana 18V Li-Ion battery system is that if the Battery Pack is too hot to be charged, the Battery Charger will NOT start charging and the light will remain Green. When the Battery Pack has cooled, the Charger will start charging. This may take up to 45 minutes.

### MAINTENANCE

The batteries have been designed to provide trouble-free life. However, like all batteries, they will eventually wear out. DO NOT disassemble battery pack and attempt to replace the cells. Handling of these batteries, especially when wearing rings and jewellery, could result in serious burns or electric shock.

To obtain the longest possible battery life, remove the battery pack from the charger once it is fully charged and ready for use.

### STORAGE

Store the battery pack where the temperature is below 27°C.

**Short term storage (weekly or monthly use)** Fully charge the battery pack and remove from charger. Store in a safe environment below 27°C

### Long term storage (6 Months)

Battery packs should have a charge state of 2 indicator lights. It is recommended that battery packs are discharged to one indicator light (by running in a tool) and charged back up to 2 indicator lights to prevent over discharge (from self discharge).

To charge the battery pack after a six months storage period, it is recommended to discharge the battery about 10%-20% (by running it in a tool) and charge afterwards to maximize the battery lifetime.



## WARNING

THE FOLLOWING ACTIONS WILL RESULT IN THE WARRANTY BEING VOID.

- IF THE TOOL HAS BEEN OPERATED ON A SUPPLY VOLTAGE OTHER THAN THAT SPECIFIED ON THE TOOL.
- IF THE TOOL SHOWS SIGNS OF DAMAGE OR DEFECTS CAUSED BY OR RESULTING FROM ABUSE, ACCIDENTS OR ALTERATIONS.
- FAILURE TO PERFORM MAINTENANCE AS SET OUT WITHIN THE INSTRUCTION MANUAL.
- IF THE TOOL IS DISASSEMBLED OR TAMPERED WITH IN ANY WAY

# KATANA®

Australia & Global

[www.katanapowertools.com.au](http://www.katanapowertools.com.au)

[enquiries@katanapowertools.com.au](mailto:enquiries@katanapowertools.com.au)

Made to Katana specifications and quality standards in China.

NOT INTENDED FOR TRADE USE

Warranty on this Katana product is given by Kincrome Australia Pty Ltd of 3 Lakeview Drive, Caribbean Park, Scoresby, Victoria, Australia (Tel +61 3 9730 7100) if this product has materials or workmanship defects (other than defects caused by abnormal or non warranted use) you can, at your cost, send the product to place of purchase, an authorised Kincrome service agent or one of Kincromes addresses for repair or replacement. Your rights under this warranty are in addition to any other rights you have under the Australian Consumer Law or other applicable laws. Our goods come with guarantees that cannot be excluded under the Australian Consumer Law. You are entitled to a replacement or refund for a major failure and compensation for any other reasonably foreseeable loss or damage. You are also entitled to have the goods repaired or replaced if the goods fail to be of acceptable quality and the failure does not amount to a major failure. For further details please visit [www.kincrome.com.au](http://www.kincrome.com.au) or call us. Due to minor changes in design or manufacture, the product you purchase may sometimes differ from the one shown on the packaging.